

WESTERN MONTANA GENEALOGICAL SOCIETY NEWSLETTER

P.O. Box 2714
Missoula, MT 59806

February 1987

Officers for 1986-1987

President:	Harold Fisher	721-5333
Vice-president:	Pat Culver	251-3529
Recording Secretary:	Lorraine Wood	549-6238
Corresponding Secretary:	Susan Doores	543-6812
Treasurer:	Phyllis Duncan	251-3177

FEBRUARY MEETING

The February meeting will be at 7:30 p.m., Thursday, February 8 in the meeting room of the Western Federal Savings and Loan, Southgate Branch, 2601 Garfield, Missoula. Visitors and guests are welcome.

Kay Kalidja, a professional photographer and newspaper columnist, will talk on photography in genealogy and publishing. She also does photo transfer of photographs to cloth or other materials.

FROM THE PUBLIC LIBRARY

Three new volumes have been added to the Genealogy Collection at the Public Library.

"Some Pioneer Families of Wisconsin: an index" edited by Betty Patterson.
R 929.3775 PATTERS.

Volumes 4 and 5 of "Tracing Your Ancestors in Minnesota: a guide to the sources" by Wiley R. Pope and Alissa L. Wiener. R 929.1072 POPE.

Volume 4 covers the West Central Minnesota counties of Big Stone, Chippewa, Douglas, Grant, Pope, Stevens, Swift, and Traverse.

Volume 5 covers the North Western Minnesota counties of Becker, Clay, Kittson, Mahnomen, Marshall, Norman, Otter Tail, Pennington, Polk, Red Lake, Roseau, and Wilkin.

AT THE BRANCH LIBRARY

The LDS Branch Library will be closed until at least the end of February for work on the building. Any films that anyone had on order will be held for the full rental period after reopening.

QUERY

From Mrs. Doris Frye, 1820 W. Hanley Rd., Mansfield, Ohio 44904.

Need information on Charles and Mary Charlotte Bradford Clauser, both born in Ohio, to Montana from LaJunta, Col., in the early 1900s. Need marriage record for daughters, Mary E. and Inez, and death dates for all four.

WARNING!!!

From "The Minnesota Genealogist" Vol 17 No 4, Dec 1986 issue:

American Genealogies Inc., Plainfield, NJ, is offering a \$29.85 Family History Book similar to those put out by Beatrice Bailey and Sharon Taylor. This one is signed "Elizabeth Ross."

Joy Reisinger, Editor - Publisher of "Lost in Canada", reports that she has received an ad for a book about "Your Family History" from a new company. The postcard is signed by Mary Whitney, Scranton, PA. Mrs. Reisinger indicates this new publication is similar to its forerunners: How-to sections, a list of people with the same surname and their addresses (obtained from sources such as telephone books). These lists do not, as they claim, include all the people with the same last name, and some on the list are deceased.

A New Problem: If anyone comes to your door asking for pictures of your parents and ancestors so that they may be published in a county atlas, check it out first. About 3000 Illinois residents and 2000 Iowans were taken in by this scheme to have their family pictures in atlases published by Richard Bentz of Prophetstown, IL. He has collected over \$372,000 for atlases that were never delivered, according to the Illinois Attorney General's Office. From Pasadena GS Newsletter, April 1986.

At least two members of our society have received advertising from the Elizabeth Ross mentioned above. She was selling a book called "The (insert your name) Family Album" and also used that name as her middle name. The return address was PO Box 5300, Scranton, PA.

Paulette Parpart
415 E. Main, Apt 1
Missoula MT 59802

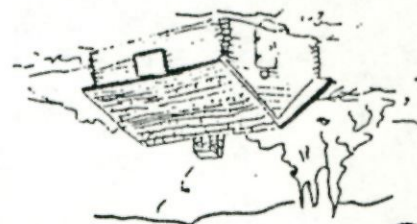

WESTERN MONTANA
GENEALOGICAL SOCIETY
P.O. Box 2714
Missoula, MT 59806